

Couvercle / Cover

Numéro de catalogue. Catalog number.	Rainure « A » (po). Groove « A » (in.)			Rainure « B » (po). Groove « B » (in.)			Longueur totale (po.) Total length (in.)	Couvercle (#catalogue) Cover (catalog #)
	ACSR	Str.	Sol.	ACSR	Str.	Sol.		
WR9	6 - 3	6 - 2	4 - 1	—	14 - 8	14 - 8	13/16	C5C
WR139	4 - 1/0	3 - 2/0	2 - 1	—	10 - 8	10 - 6	1 - 1/2	C5C
WR159	6 - 2	6 - 1	6 - 2	6 - 2	6 - 1	6 - 2	1 - 7/16	C5C
WR189	3 - 1/0	2 - 2/0	1	6 - 2	6 - 1	6 - 2	1 - 11/16	C5C
WR259	1 - 1/0	1/0 - 2/0	—	1 - 1/0	1/0 - 2/0	—	1 - 7/8	C7C
WR279	1 - 2/0	1/0 - 3/0	—	1 - 2/0	1/0 - 3/0	—	1 - 13/16	C7C
WR289	1/0 - 2/0	2/0 - 3/0	—	6 - 2	6 - 1	6 - 1	1 - 13/16	C7C
WR299	1/0 - 2/0	2/0 - 3/0	—	6 - 4	6 - 3	6 - 2	1 - 1/2	C7C
WR359	3/0 - 4/0	3/0 - 4/0	—	6 - 4	6 - 3	6 - 2	1 - 7/8	C7C
WR369	3/0 - 4/0	3/0 - 4/0	—	4 - 1	3 - 1/0	1	1 - 7/8	C7C
WR379	3/0 - 4/0	4/0	—	6 - 2	6 - 1	6 - 1	1 - 13/16	C7C
WR389	3/0 - 4/0	3/0 - 4/0	—	1/0 - 2/0	2/0 - 3/0	—	2 - 3/16	C7C
WR399	3/0 - 4/0	3/0 - 4/0	—	1 - 2/0	1/0 - 2/0	—	2 - 3/16	C7C
WR419	3/0 - 4/0	3/0 - 4/0	—	3/0 - 4/0	3/0 - 4/0	—	2 - 7/16	C7C
WR502	3/0 - 4/0	3/0 - 4/0	—	—	10 - 8	10 - 6	1 - 1/2	C7C
WR699	266 - 397 18/1	250 - 400	—	6 - 4	6 - 3	6 - 2	2	C9
WR715	266 - 397 18/1	250 - 400	—	6 - 2/0	6 - 2/0	6 - 3/0	2	C9
WR719	266 - 397 18/1	250 - 400	—	3 - 2/0	2 - 2/0	1 - 3/0	2	C9
WR799	266 - 477 18/1	250 - 500	—	6 - 4	6 - 3	6 - 2	2	C9L
WR815	4/0 - 477 26/7	4/0 - 556	—	6 - 2/0	6 - 2/0	6 - 3/0	2	C9
WR819	336 - 477 26/7	336 - 556	—	3 - 2/0	2 - 2/0	1 - 3/0	2	C9
WR835	4/0 - 477 26/7	4/0 - 556	—	1/0 - 4/0	1/0 - 4/0	2/0 - 4/0	2	C9
WR885	4/0 - 477 18/1	4/0 - 500	—	4/0 - 477 18/1	4/0 - 500	—	3	C9L
WR929	300 - 556 18/1	336 - 600	—	300 - 556 18/1	336 - 600	—	4 - 3/4	C9L

**CONNECTEUR À GORGE PARALLÈLE / SQUEEZE-ON CONNECTOR**

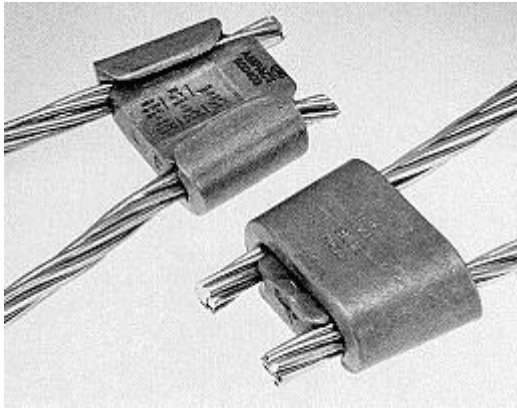

**AMPACT**

Dimension « course » câble.  « Run » cable size.	Dimension « dérivation » câble.  « Tap » cable size.
1192.5 mcm	#6 awg - 1192.5 mcm
1033.5 mcm	#6 awg - 1033.5 mcm
795 mcm	#6 awg - 795 mcm
556.5 mcm	#6 awg - 556.5 mcm
477 mcm	#6 awg - 477 mcm
397.5 mcm	#6 awg - 397.5 mcm
350 mcm	#6 awg - 350 mcm
336.4 mcm	#6 awg - 336.4 mcm
266.8 mcm	#6 awg - 266.8 mcm
4/0 awg	#6 - 4/0 awg
3/0 awg	#6 - 3/0 awg
2/0 awg	#6—2/0 awg
1/0 awg	#14 - 1/0 awg
#2 awg	#14 - #2 awg
#4 awg	#14 - #4 awg
#6 awg	#14 - #6 awg
#8 awg	#14 - #8 awg

Connecteurs / Connectors



Numéro de catalogue.  Catalog number	Couleur connecteur  Tap color
602061	Rouge / Red
602080	Bleu / Blue
602107	Jaune / Yellow jusqu'à / up to 556.5 mcm
602284 (Paire / Pair)	Jaune / Yellow 795 mcm et plus / and up



Petit outil (cartouche bleu, rouge, blanc).  
 Small tool (blue, red, white taps).

Gros outil (cartouche jaune).  
 Large tool (yellow tap).



Cartouche / Cartridge

Numéro de catalogue.  Catalog number	Couleur connecteur  Tap color	Outil  Tool
<b>69338-1</b>	Bleu Blue	Petit Small
<b>69338-2</b>	Rouge Red	Petit Small
<b>69338-4</b>	Jaune Yellow	Gros Large
<b>69338-5</b>	Blanc White	Petit Small

## AMP

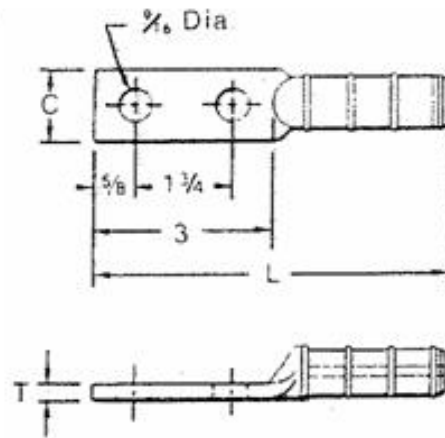

**Fig. 1**

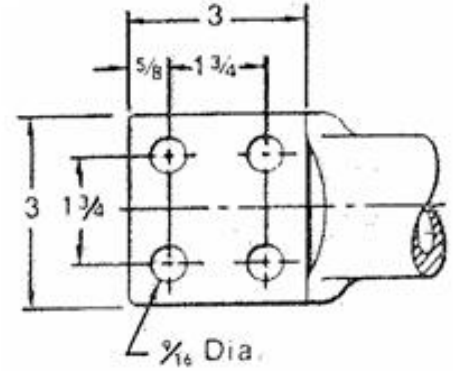

**Fig. 2**

Numéro de catalogue. Catalog number.	Conducteur Conductor		Fig.	C	L	T	Outils, ensemble de matrice et nombres de sertissages Tools, die set and number of crimps
	ACSR	Aluminum					
YCA4RL-2N	4 (6-1, 7-1)	4 (7)	1	7/8	6	3/8	U243 (2)
YCA2RL-2N	2 (6-1)	2 (7)	1	7/8	6	3/8	U243 (2)
YCA25RL-2N	1/0 (6-1)	1/0 (7)	1	1-1/8	7	3/8	U247 (3)
YCA26RL-2N	2/0 (6-1)	2/0 (7)	1	1-1/8	6-1/2	3/8	U659 (3)
YCA27RL-2N	3/0 (6-1)	3/0 (7)	1	1-1/4	6-1/2	3/8	U658 (3)
YCA28RL-2N	4-0 (6-1)	4/0 (7)	1	1-1/2	6-1/2	3/8	U654 (3)
YCA30R-2N	266.8 (18-1, 6-7, 26-7)	266.8 (7, 19)	1	1-1/2	3-3/4	3/8	U251 (4)
YCAK30R-4N	266.8 (18-1, 6-7, 26-7)	266.8 (7, 19)	2	3	7-3/8	3/8	U251 (4)
YCA321R-2N	336.4 (18-1)	336.4 (19) -	1	1-1/2	7	3/8	U321 (4)
YCAK321R-4N	336.4 (18-1)	350 (19,37,61)	2	3	7-1/8	3/8	U321 (4)
YCA33R-2N	336.4 (26-7, 30-7)	397.5 (19)	1	1-5/8	7-1/4	3/8	U316 (4)
YCAK33R-4N	397.5 (18-1)	397.5 (19)	2	3	7-3/8	3/8	U316 (4)
YCA35R-2N	397.5 (26-7, 30-7)	477 (19, 37) -	1	1-7/8	7-1/2	3/8	U317 (4)
YCAK35R-4N	397.5 (26-7, 30-7)	500 (37, 61)	2	3	7-3/8	3/8	U317 (4)
YCA37R-2N	556.5 (18-1)	556.5 (19, 37)	1	2	8-1/8	3/8	U261 (5)
YCAK37R-4N	477 (24-7, 26-7, 30-7)	556.5 (19, 37)	2	3	8-1/8	3/8	U261 (5)
YCA39R-2N	556.5 (24-7, 26-7)	—	1	2-1/8	8-1/8	1/2	U608 (6)
YCAK39R-4N	556.5 (24-7, 26-7)	—	2	3	8-1/8	1/2	U608 (6)

**Matériel:** Aluminium  
**Material:** Aluminum

\*Matrice en U avec adaptateur P-UADP.  
\*U die with adapter P-UADP.

**CONNECTEUR COMPRESSIBLE / COMPRESSIBLE CONNECTOR**

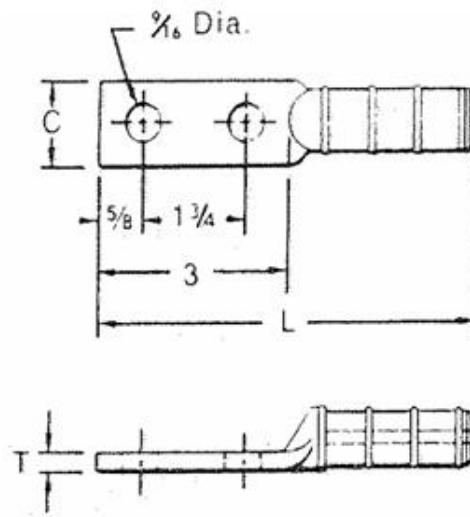

Connecteurs / Connectors

Numéro de catalogue. Catalog number.	Conducteur Conductor	Couleur Colour	C	L	T	Outils, ensemble de matrice et nombres de sertissages Tools, die set and number of crimps
						Y35, Y39, Y46*
<a href="#">YA1C-2N</a>	1 AWG	Green	0.81	4.82	0.12	U1CRT-1 (2) / U4CABT (2)
<a href="#">YA2C-2N</a>	2 AWG	Gray	0.81	4.45	0.12	U4CRT (2) / U6CABT (2)
<a href="#">YA25-2N</a>	1/0 AWG	Pink	0.81	4.81	0.11	U25RT (2) / U2CABT (2)
<a href="#">YA26-2N</a>	2/0 Str.	Black	0.83	4.97	0.12	U26RT (2)
<a href="#">YA27-2N</a>	3/0 Str.	Orange	0.91	5.01	0.13	U27RT (2)
<a href="#">YA28-2N</a>	4/0 Str.	Purple	1.02	5.17	0.14	U28RT (2)
<a href="#">YA29-2N</a>	250 kcmil	Yellow	1.11	5.21	0.16	U29RT (2)
<a href="#">YA30-2N</a>	300 kcmil	White	1.20	5.64	0.16	U30RT (4) / U28ART (4)
<a href="#">YA31-2N</a>	350 kcmil	Red	1.29	5.68	0.18	U31RT (4) / U29ART (4)
<a href="#">YA32-2N</a>	400 kcmil	Blue	1.38	5.85	0.19	U32RT (4) / U30ART (4)
<a href="#">YA34-2N</a>	500 kcmil	Brown	1.52	6.06	0.23	U34RT (4) / U31ART (4)
<a href="#">YA36-2N</a>	600 kcmil	Green	1.69	6.59	0.27	U36RT (4) / U32ART (4)
<a href="#">YA39-2N</a>	750 kcmil	Black	1.89	6.87	0.27	U39RT (4) / U36ART (4)
<a href="#">YA44-2N</a>	1000 kcmil	White	2.17	7.14	0.33	P44RT (4)

**Matériel:** Cuivre étamé

**Material:** Tin plated copper

## CONNECTEUR COMPRESSIBLE / COMPRESSIBLE CONNECTOR



ACSR AND ALL ALUMINUM

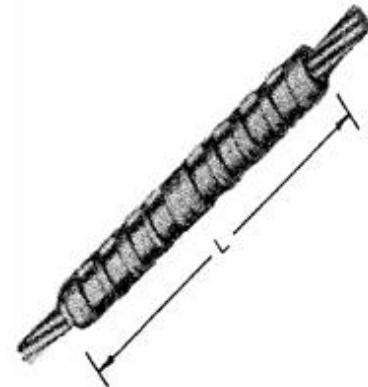

ALL ALUMINUM ONLY

Numéro de catalogue. Catalog number.	Conducteur Conductor	L	Outils, ensemble de matrice et nombres de sertissages Tools, die set and number of crimps	Numéro de catalogue. Catalog number.	Conducteur Conductor	L	Outils, ensemble de matrice et nombres de sertissages Tools, die set and number of crimps
			Y35, Y39, Y46*				Y35, Y39, Y46*
YDS4RL	4 ACSR (6-1) (7-1) 4 Alum. (6) 4 S.B. 100% (6-1)	11.91	U243 (6)	YDS6CA	6ASC (7)	3.00	U161 (1)
YDS2RL	2 ACSR (6-1) 2 Alum. (7) 2 S.B. 100% (6-1)	10.19	U243 (5)	YDS4CA	4ASC (7)	2.62	U162 (1)
YDS25RL	1/0 ACSR (6-1) 1/0 Alum. (7) 1/0 S.B. 100% (6-1)	14.76	U167 (16) U247 (8)	YDS2CA	2ASC (7)	3.88	U163 (2)
YDS26RL	2/0 ACSR (6-1) 2/0 Alum. (7) 2/0 S.B. 100% (6-1)	16.00	U659 Crimps overlap	YDS25AT	1/0 ASC (7)	7.25	U243 (3)
YDS27RL	3/0 ACSR (6-1) 3/0 Alum. (7) 3/0 S.B. 100% (6-1)	18.18	U658 Crimps overlap	YDS26AT	2/0 ASC (7)	9.25	U245 (4)
YDS28RL	4/0 ACSR (6-1) 4/0 Alum. (7) 4/0 S.B. 100% (6-1)	18.50	U654 Crimps overlap	YDS27AT	3/0 ASC (7)	7.25	U247 (4)
				YDS28AT	4/0 ASC (7)	10.50	U249 (6)
				YDS291AT	266.8 ASC (7)	8.62	U251 (7)
				YDS301AT	336.4 ASC (7)	9.88	U321 (8)
				YDS311AT	397.5 (19)	12.25	U468 (10)
				YDS331AT	477 (19)	12.75	U317 (9)
				YDS351AT	556.5 (19)	12.75	U261 (9)

\*Matrice en U avec adaptateur P-UADP.

\*U die with adapter P-UADP.

**Matériel:** Aluminium

**Material:** Aluminum

**CONNECTEUR COMPRESSIBLE / COMPRESSIBLE CONNECTOR**

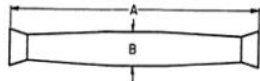

Ref Dimension A & B

**ANDERSON FARGO™**



**GL**

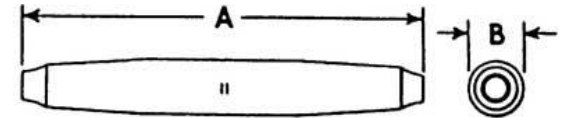

**GLS**

Numéro de catalogue. Catalog number.	Conducteur Conductor	MIN-MAX Diam cable po / in	A po / in	B po / in	Code de couleur Color code
<b>GL4042A</b>	4 & 2 ACSR	.220 –.320	12	1	Rouge & Orange
<b>GL4076A</b>	1/0 - 2/0 ACSR	.355 –.470	18	1.4	Jaune & Gris
<b>GL4098</b>	3/0 - 4/0 ACSR	.450 –.595	22	1.7	Rose & Noir
Câbles d'hauban / Guy wire					
<b>GLS5040</b>	1/4 EHS	0.215 - 0.270	8.3	1.13	
<b>GLS5041</b>	5/16 EHS	0.270 - 0.315	8.6	1.22	
<b>GLS5042</b>	3/8 EHS	0.325 - 0.392	10	1.48	
<b>GLS5043</b>	7/16 EHS	0.392 - 0.458	11	1.6	

**Matériel:** Aluminium  
**Material:** Aluminum

## ÉPISSURE AUTOMATIQUE / AUTOMATIC SPLICE

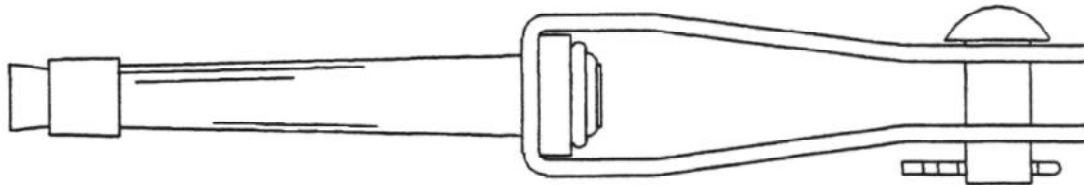

Fin de course automatique. Câble aluminium ou ACSR: #4, #2, 1/0, 2/0, 3/0, 4/0, 266.8, 336.4  
Automatic dead end. Aluminum or ACSR cable: #4, #2, 1/0, 2/0, 3/0, 4/0, 266.8, 336.4

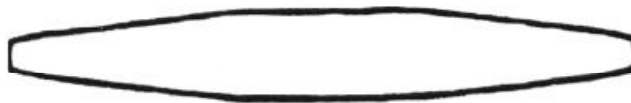

Épissure automatique. Câble cuiivre: #8, #6, #4, #3, #2, #1, 1/0, 2/0, 3/0, 4/0  
Automatic splice. Copper cable: #8, #6, #4, #3, #2, #1, 1/0, 2/0, 3/0, 4/0



Fin de course automatique. Câble cuiivre: #8, #6, #4, #3, #2, #1, 1/0, 2/0, 3/0, 4/0  
Automatic dead end. Copper cable: #8, #6, #4, #3, #2, #1, 1/0, 2/0, 3/0, 4/0

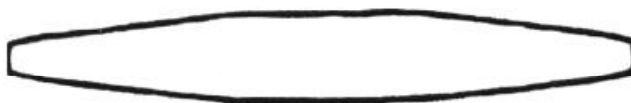

Épissure automatique. Câble acier: 3/16", 1/4", 5/16", 3/8", 7/16", 1/2"  
Automatic splice. Steel cable: 3/16", 1/4", 5/16", 3/8", 7/16", 1/2"



Fin de course automatique. Câble acier: 3/16", 1/4", 5/16", 3/8", 7/16", 1/2"  
Automatic dead end. Steel cable: 3/16", 1/4", 5/16", 3/8", 7/16", 1/2"

## ÉPISSURE AUTOMATIQUE / AUTOMATIC SPLICE



## Fin de course compressible / Compression dead-ends

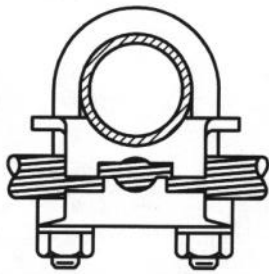

**Type GAR**

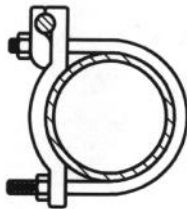
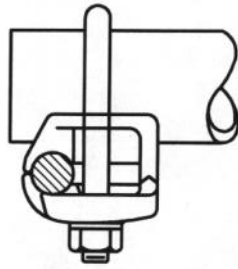

**Type GAR\_BU**

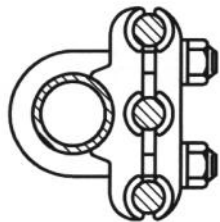
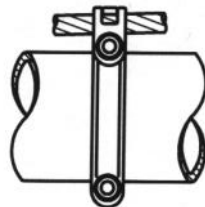

**Type GK**

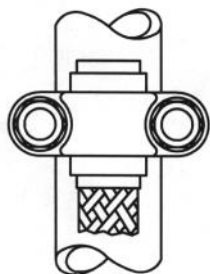
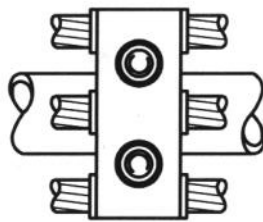

**Type GG**

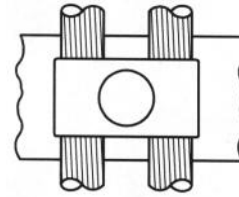
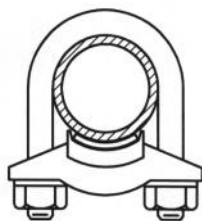

**Type GC**

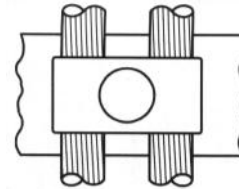
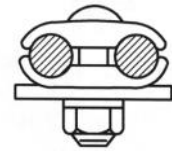

**Type GCM**

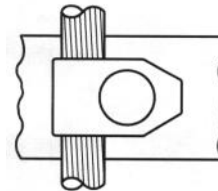

**Type GB**

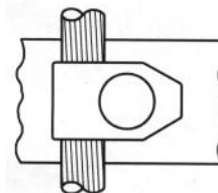
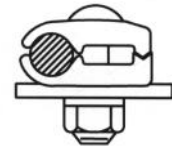

**Type GBM**



**CONNECTEUR DE M.A.L.T. / GROUNDING CONNECTOR**



Pour tige de MALT en acier Galvaniser.  
 For galvanized ground rods

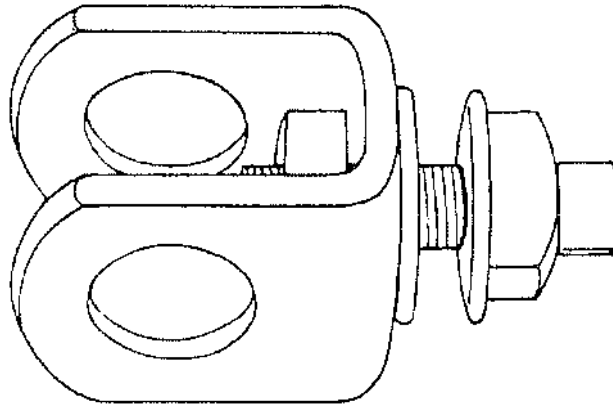

Numéro de catalogue. Catalog number.	Diamètre de la tige Rod diameter	
	Po. In.	Cm
<b>9752</b>	5/8 - 3/4	1.59 - 1.91

Pour tige de MALT en acier cuivrée.  
 For copper clad ground rods

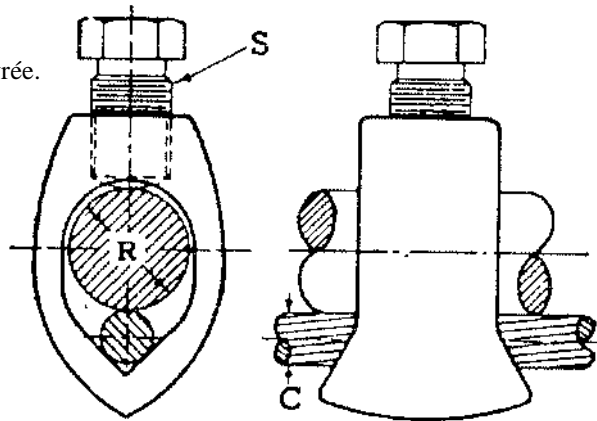

Numéro de catalogue. Catalog number.	Dimension « S » (po). « S » Dimension (in.)	Diamètre de la tige « R » (po). Rod diameter « R » (in.)	Dimension du câble Câble size	
			Min. Sol.	Max. Str.
<b>GRC3426</b>	1/2	5/8'' - 3/4''	10	2/0

Connecteurs / Connectors

## CONNECTEUR DE M.A.L.T. / GROUNDING CONNECTOR



TYPE YGL-C  
Câble: #6 - 500 mcm

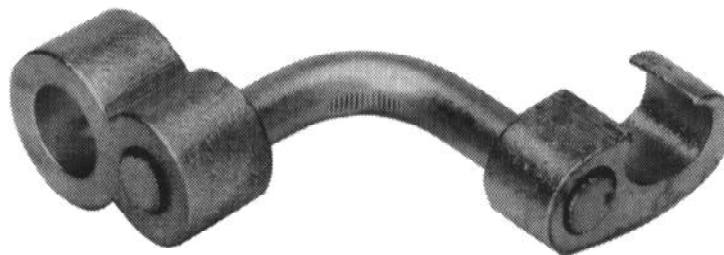

TYPE YGLR-C  
Câble: #2 - 500 mcm  
Tige / Rod: 1/2", 5/8", 3/4".

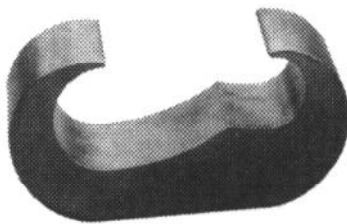

TYPE YGHC-C  
Câble: #6 - 500 mcm



TYPE YGHR-C  
Câble: #2 - 500 mcm



TYPE YGHP-C  
Câble: #6 - 500 mcm

## CONNECTEUR DE M.A.L.T. COMPRESSIBLE COMPRESSIBLE GROUNDING CONNECTOR

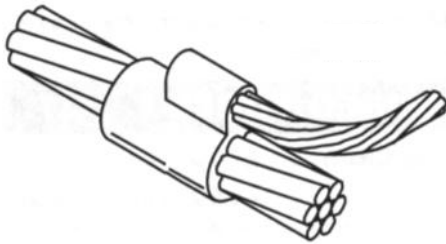

TYPE « PC »

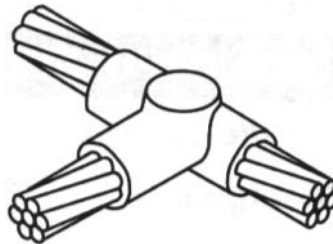

TYPE « TA »

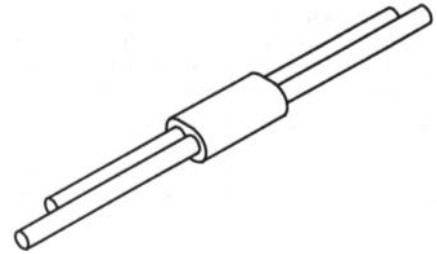

TYPE « PG »

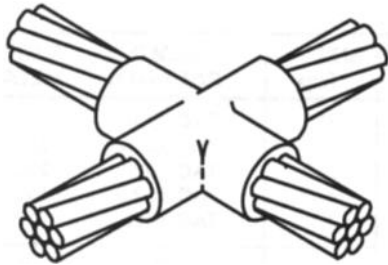

TYPE « XA »

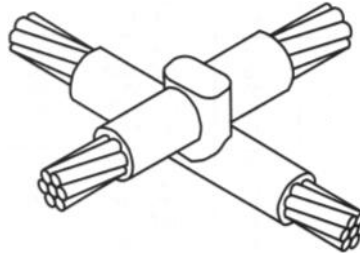

TYPE « XB »

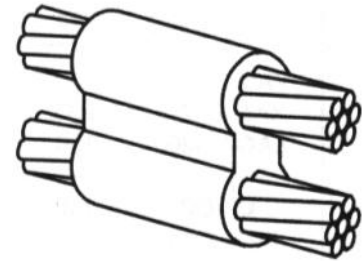

TYPE « PT »

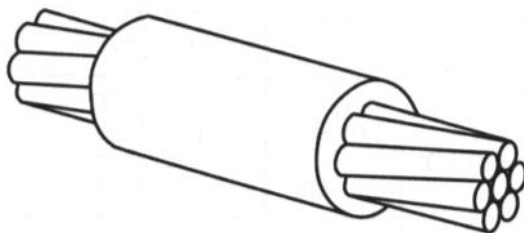

TYPE « SS »



TYPE « PH »

**Note:** Soudure Câble à Câble  
Cable to Cable welding

**ERICO CADWELD**

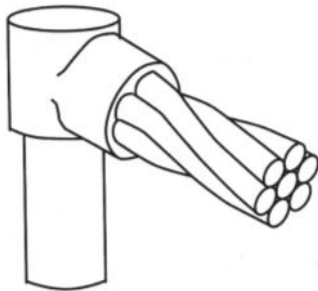

TYPE « GR »

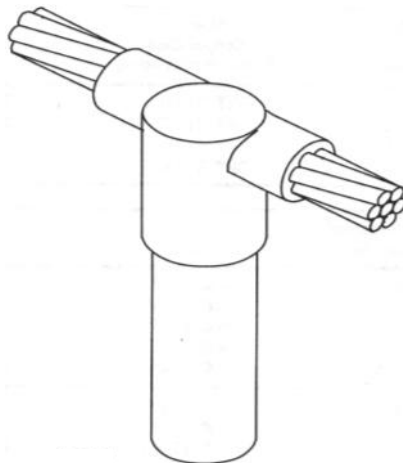

TYPE « GT »

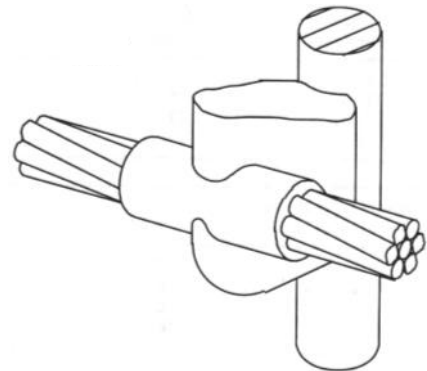

TYPE « GY »



TYPE « GB »

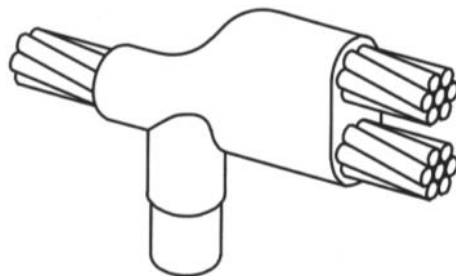

TYPE « NC »

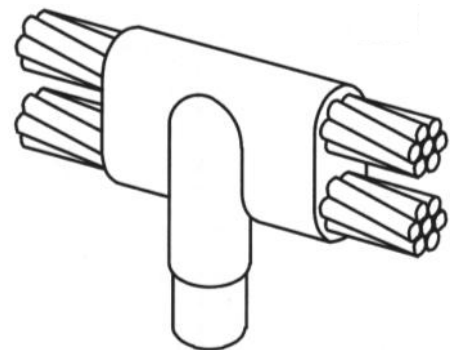

TYPE « ND »

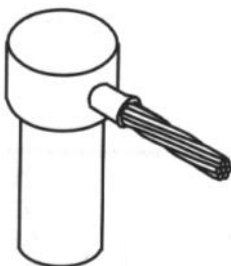

TYPE « GR »  
ONE-SHOT

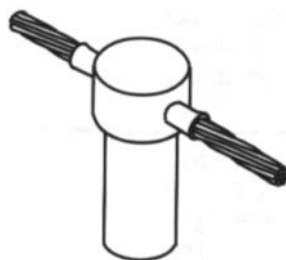

TYPE « GT »  
ONE-SHOT



TYPE « NT »  
ONE-SHOT

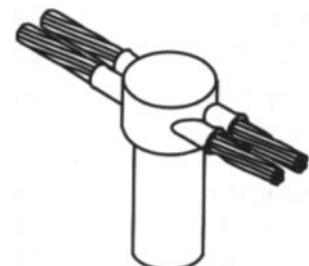

TYPE « NX »  
ONE-SHOT

**Note:** Soudure Câble à Tige de M.A.L.T.  
Cable to Ground rod welding

ERICO CADWELD

Connecteurs / Connectors

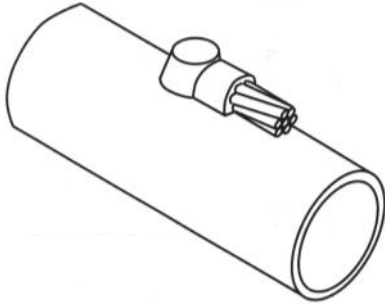

TYPE « HA »  
 TUYAU / TUBE

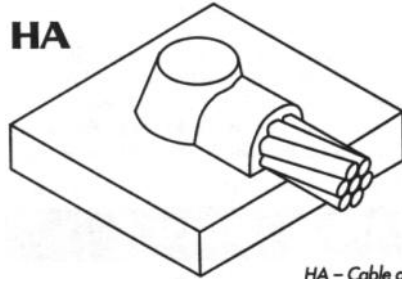

HA - Cable on  
 TYPE « HA »  
 SURFACE PLATE / FLAT

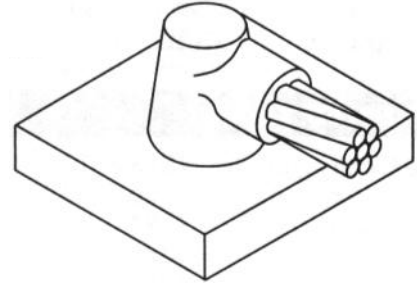

TYPE « HS »

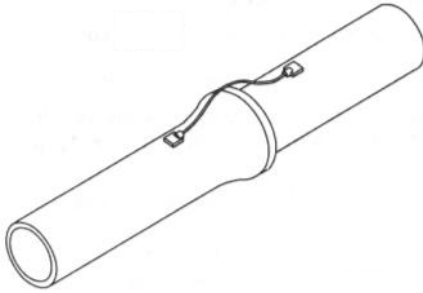

TYPE « HB »  
 FONTE / CAST IRON

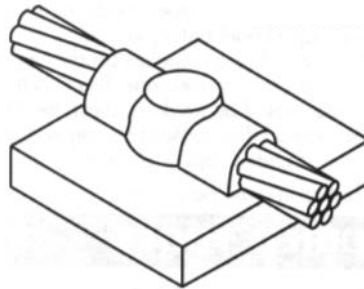

TYPE « HC »

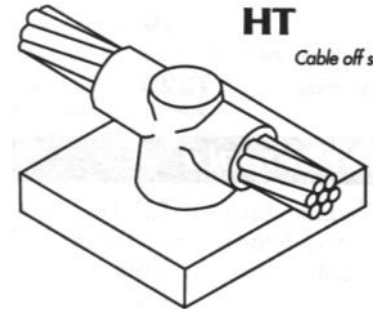

HT  
 Cable off s  
 TYPE « HT »

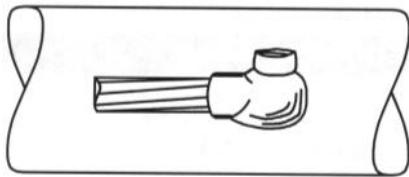

TYPE « VN »

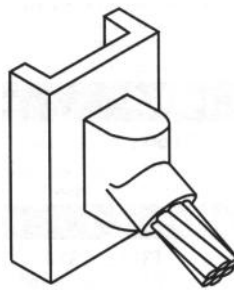

TYPE « VS »  
 SURFACE PLATE  
 FLAT

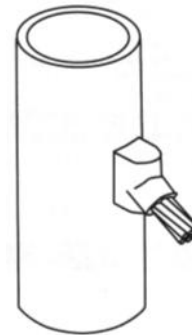

TYPE « VS »  
 TUYAU / TUBE

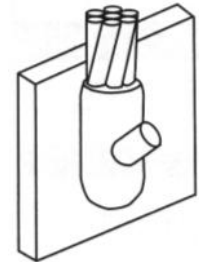

TYPE « VF »

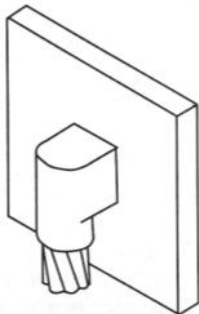

TYPE « VB »

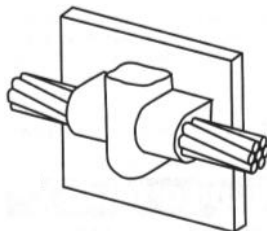

TYPE « VG »

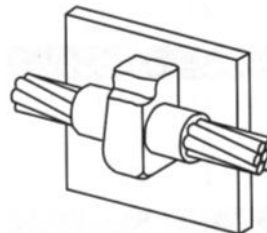

TYPE « VT »

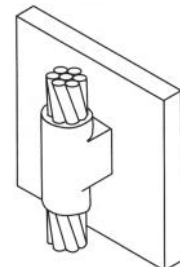

TYPE « V V »

**Note:** Soudure Câble à Tube ou Soudure Câble à Plaque / Cable to Tube welding or Cable to Plate welding

ERICO CADWELD

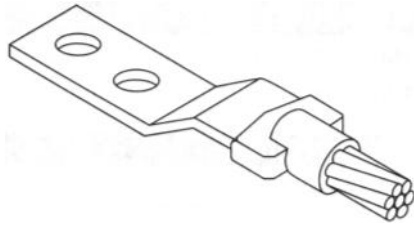

TYPE « LA »  
COSSE EN CUIVRE  
COPPER LUG

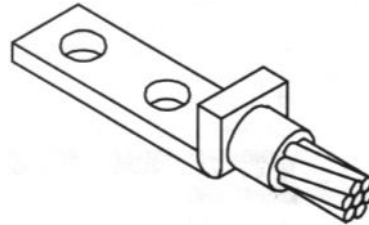

TYPE « GL »  
COSSE EN CUIVRE  
COPPER LUG

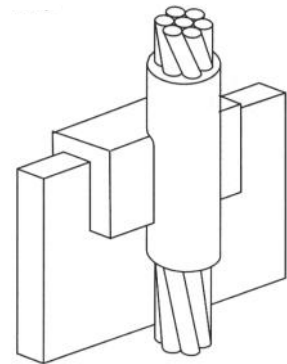

TYPE « LQ »  
CABLE - BARRE  
CABLE - BUS BAR

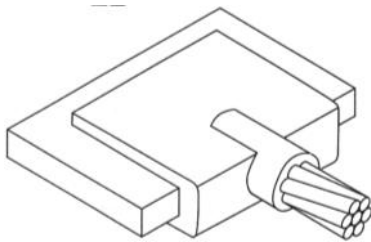

TYPE « LJ »  
CABLE - BARRE  
CABLE - BUS BAR

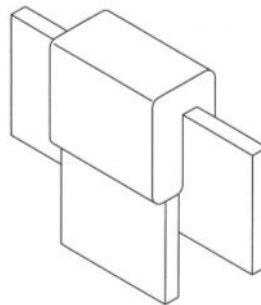

TYPE « BQ »  
BARRE - BARRE  
BUS BAR - BUS BAR

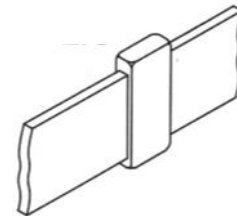

TYPE « BA »  
BARRE - BARRE  
BUS BAR - BUS BAR

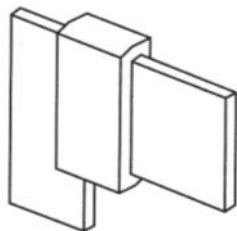

TYPE « EP »  
BARRE - BARRE  
BUS BAR - BUS BAR

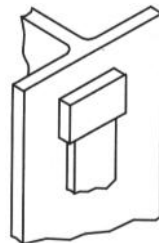

TYPE « BW »  
BARRE - ACIER  
BUS BAR - STEEL

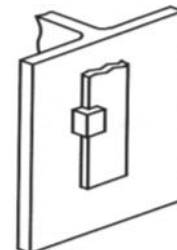

TYPE « CF »  
BARRE - ACIER  
BUS BAR - STEEL

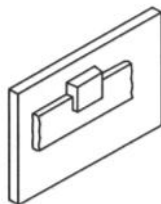

TYPE « CC »  
BARRE - ACIER  
BUS BAR - STEEL

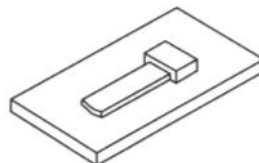

TYPE « CG »  
BARRE - ACIER  
BUS BAR - STEEL

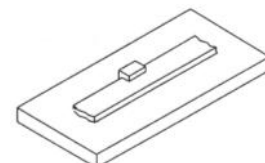

TYPE « CH »  
BARRE - ACIER  
BUS BAR - STEEL

Connecteurs / Connectors

**ERICO CADWELD**

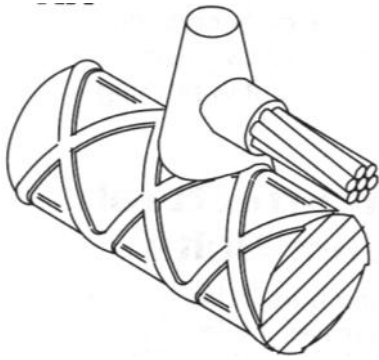

TYPE « RR »  
 CABLE - TIGE ARMATURE  
 CABLE - REBAR

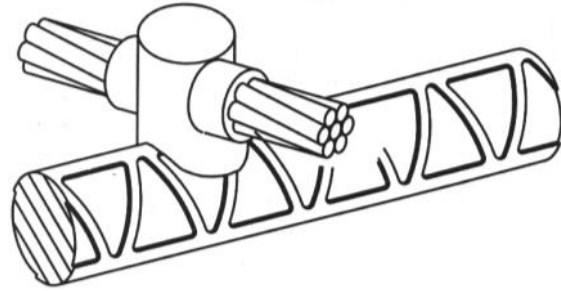

TYPE « RD »  
 CABLE - TIGE ARMATURE  
 CABLE - REBAR

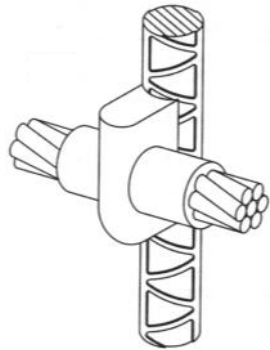

TYPE « RC »  
 CABLE - TIGE ARMATURE  
 CABLE - REBAR

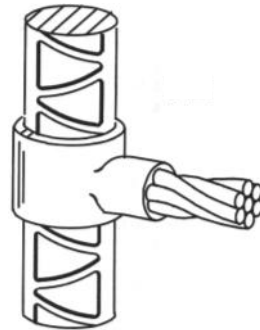

TYPE « RJ »  
 CABLE - TIGE ARMATURE  
 CABLE - REBAR

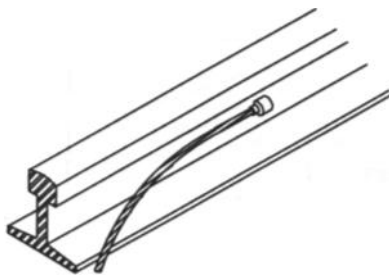

TYPE « ST »  
 CABLE - RAIL

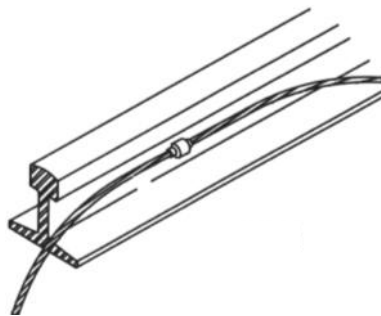

TYPE « TP »  
 CABLE - RAIL

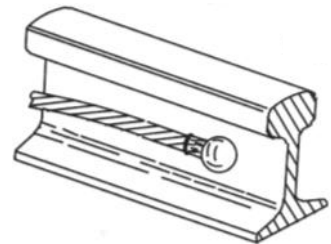

TYPE « W »  
 CABLE - RAIL

**ERICO CADWELD**

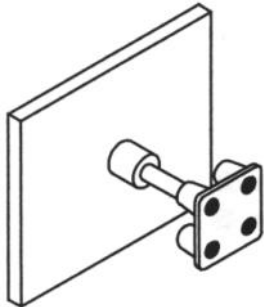

TYPE « HV »  
PLAQUE DE M.A.L.T.  
CAST GROUND PLATE

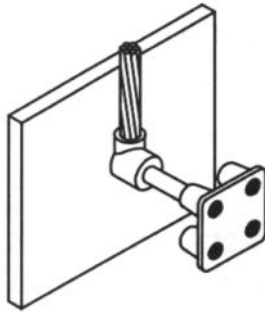

TYPE « HV / VF »  
CABLE - PLAQUE DE M.A.L.T.  
CABLE - CAST GROUND PLATE

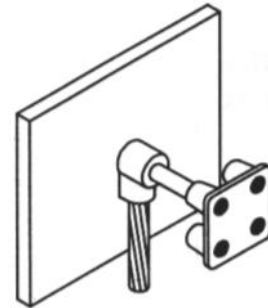

TYPE « HV / VE »  
CABLE - PLAQUE DE M.A.L.T.  
CABLE - CAST GROUND PLATE

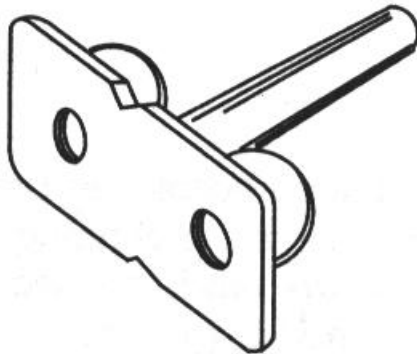

PLAQUE DE M.A.L.T.  
CAST GROUND PLATE

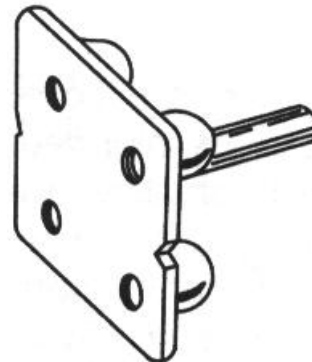

PLAQUE DE M.A.L.T.  
CAST GROUND PLATE

**ERICO CADWELD**

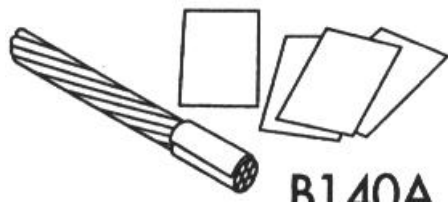

**B140A**  
**FEUILLARD À SERTIR**  
**WRAP SLEEVE**

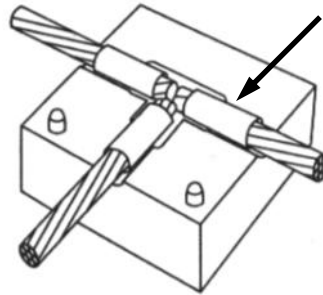

**MANCHON ADAPTEUR**  
**ADAPTER SLEEVE**

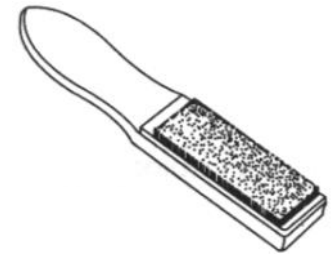

**T313**  
**BROSSE À CABLE**  
**CABLE BRUSH**

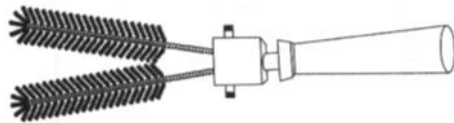

**T314**  
**BROSSE À CABLE**  
**CABLE BRUSH**

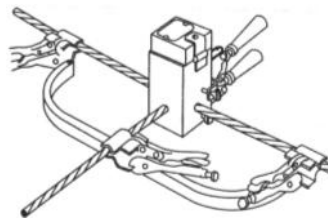

**B265**  
**PINCE À CABLE**  
**CABLE CLAMP**



**T321**  
**RAPE**  
**RASP**



**T111**  
**TORCHE**  
**TORCH**

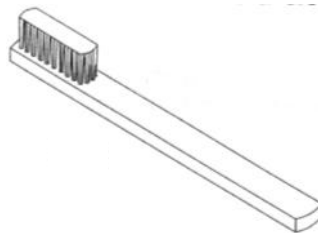

**T394**  
**BROSSE POUR MOULE**  
**MOLD CLEANING BRUSH**

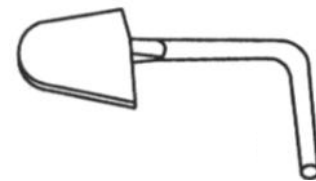

**NETOYEUR DE MOULE**  
**SLAG REMOVAL SPADE**



**ASSIETTE POUR POUDDRE**  
**DISK FOR WELD METAL**

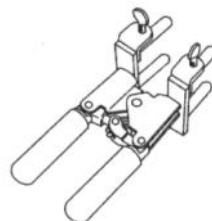

**# L160 & L159**  
**POIGNÉE POUR MOULE**  
**HANDLE FOR MOLD**

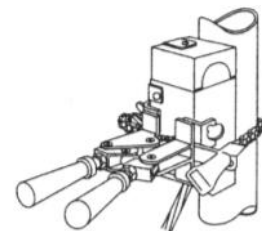

**POIGNÉE A CHAÎNE POUR MOULE**  
**HANDLE WITH CHAIN FOR MOLD**

**ERICO CADWELD**



MANCHON À ENFONCER TIGE  
ROD DRIVING SLEEVE

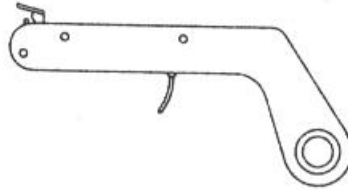

BRIQUET  
LIGHTER

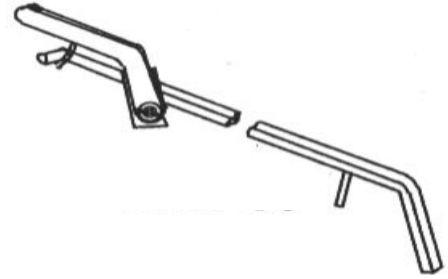

EXTENSION À BRIQUET, 30"  
30" LIGHTER EXTENSION

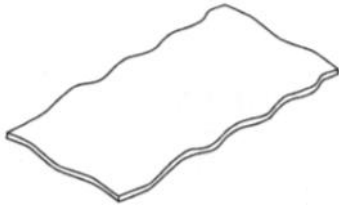

T306 TOILE CÉRAMIQUE  
CERAMIC BLANKET



T329 LIME / FILE



T305 TOURNEVIS  
SCREWDRIVER



T304 PINCES  
PLIERS

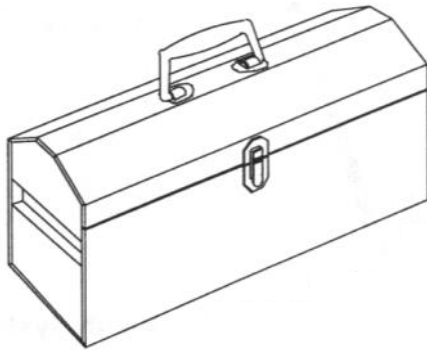

T396 BOITE À OUTILS  
TOOL BOX

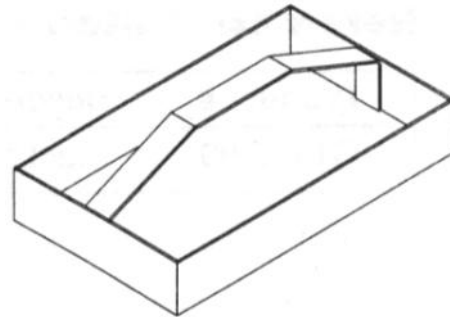

T331 PLATEAU À OUTILS  
TOOL TRAY

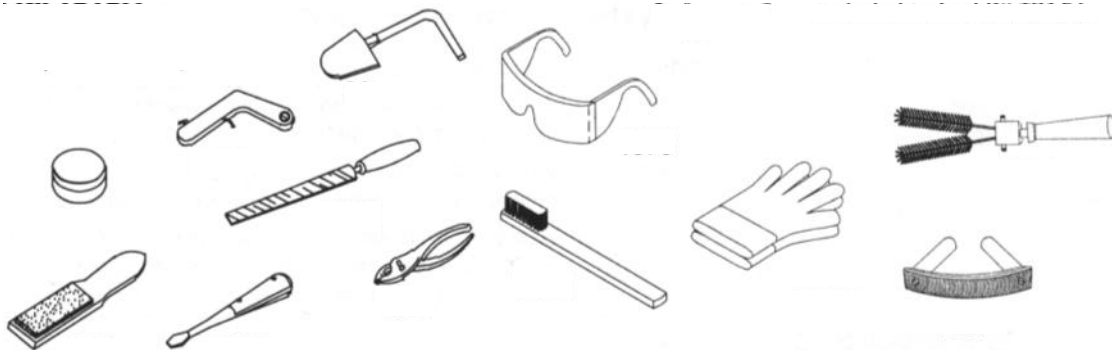

T315A

ENSEMBLE D'OUTILLAGE. INCLUANT: T396, B136A, T320, T329, T313, T304, T305, T394, T314, T321, GANTS, LUNETTES  
ET ENSEMBLE D'ASSIETTE POUR POUDDRE.

TOOL KIT. INCLUDING: T396, B136A, T320, T329, T313, T304, T305, T394, T314, T321, GLOVES, GLASSES AND DISK KIT.

Connecteurs / Connectors

# ERICO CADWELD

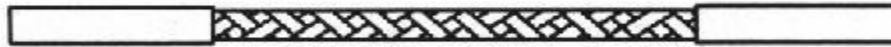
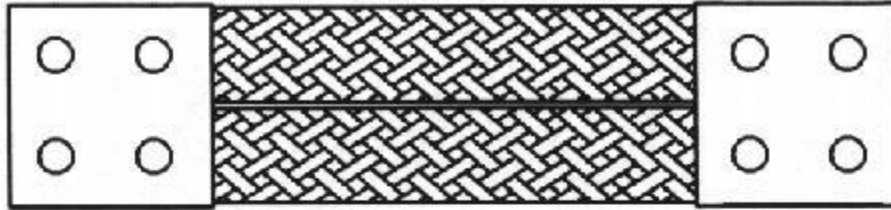

Connecteurs / Connectors

Plusieurs dimensions et configurations disponibles.  
Many sizes and configurations available.

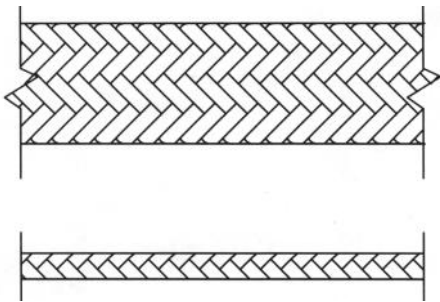

Tresse aussi disponible au pied.  
Braid also available by the foot.

## TRESSE / BRAID

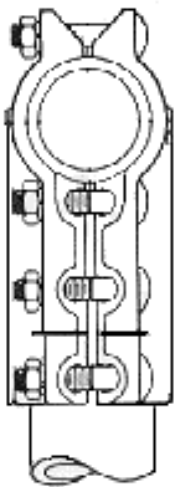

Connecteur en « T »  
 « T » connector

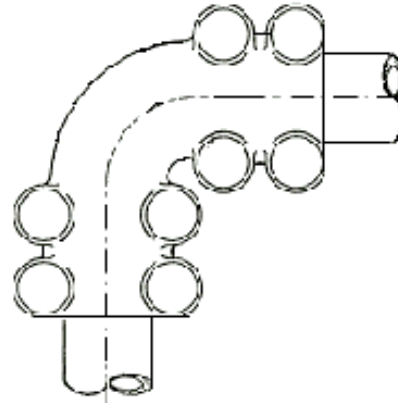
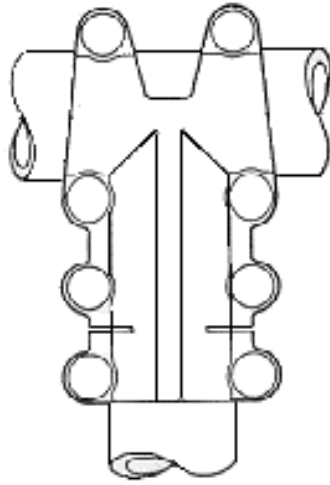

Connecteur coude  
 Elbow connector

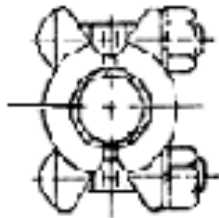
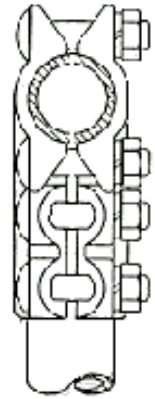

Connecteur droit  
 Coupler connector

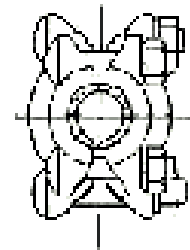
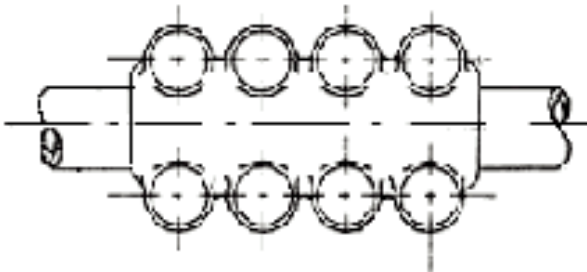

Connecteur reducteur droit  
 Reducing coupler connector

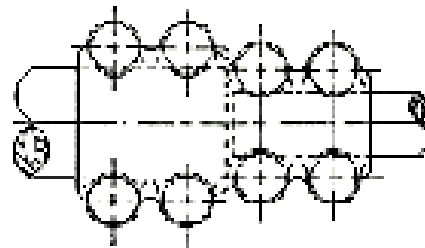

Plusieurs dimensions et configurations disponibles.

Contactez-nous

Many sizes and configurations available.

Contact-us

**Matériel:** Cuivre ou aluminium

**Material:** Copper or aluminum

## CONNECTEURS / CONNECTORS

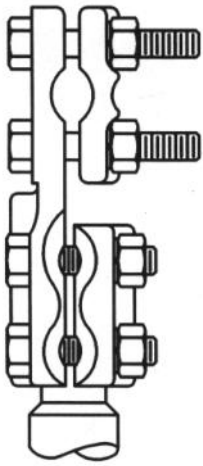

Connecteur goujon  
 Stud connector

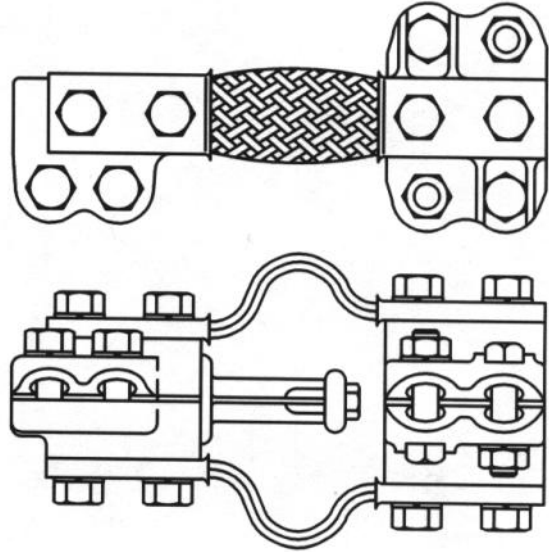
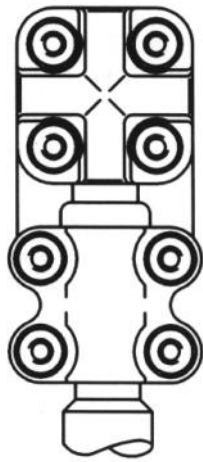

Connecteur goujon expansible  
 Flexible stud connector

Connecteurs / Connectors

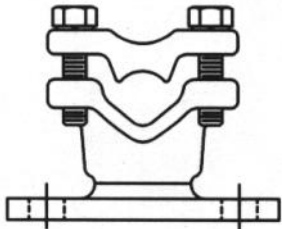
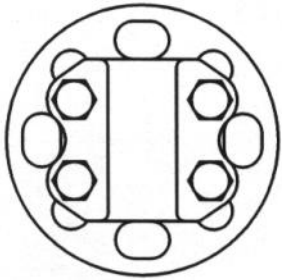

“Bus support”  
 Bus support

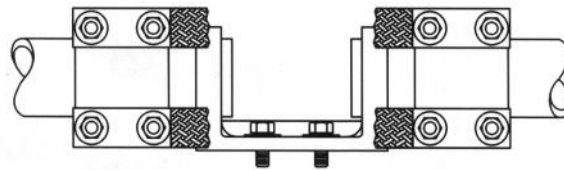
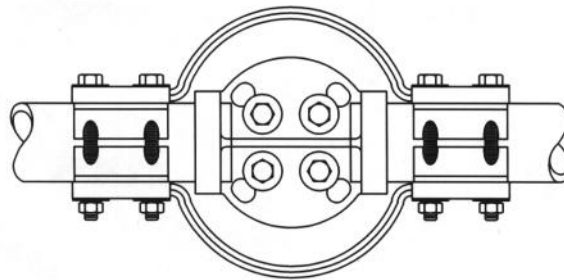

“Bus support” expansible  
 Flexible bus support

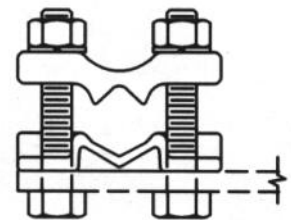
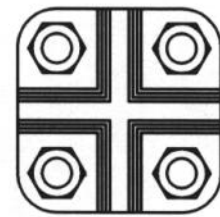

Connecteur universel  
 Universal connector

Plusieurs dimensions et configurations disponibles.  
 Contactez-nous  
 Many sizes and configurations available.  
 Contact-us

**Matériel:** Cuivre ou aluminium  
**Material:** Copper or aluminum

## CONNECTEURS / CONNECTORS

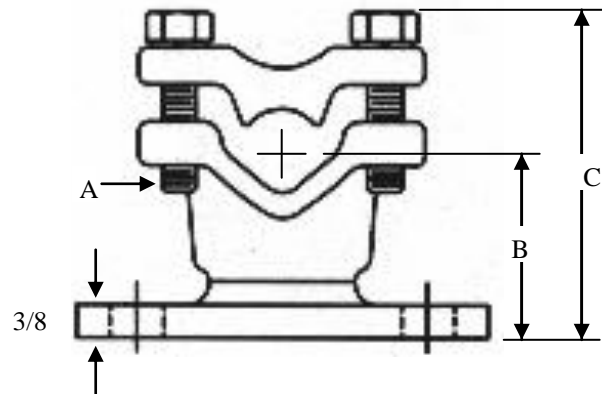
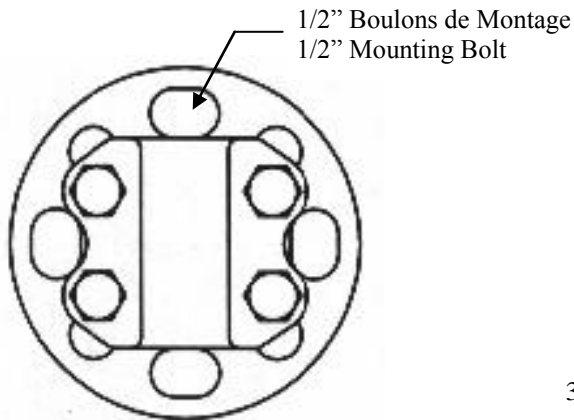

Numéro de catalogue. Catalog number.	Cercle de boulonnage Bolt Circle	A	B	C	Conducteurs Conductors	
					Tube	Cable
<b>RD129003</b>	3"	3/8"	2"	3 1/2"	3/8" - 1"	#2 - 1000 MCM
<b>RD129003K</b> (ÉTAMÉ/TINNED)	3"	3/8"	2"	3 1/2"	3/8" - 1"	#2 - 1000 MCM

Connecteurs / Connectors

**Matériel:** Cuivre ou Cuivre étamé  
**Material:** Copper or Tinned Copper

## BRIDE PORTE CABLE / BUS SUPPORT

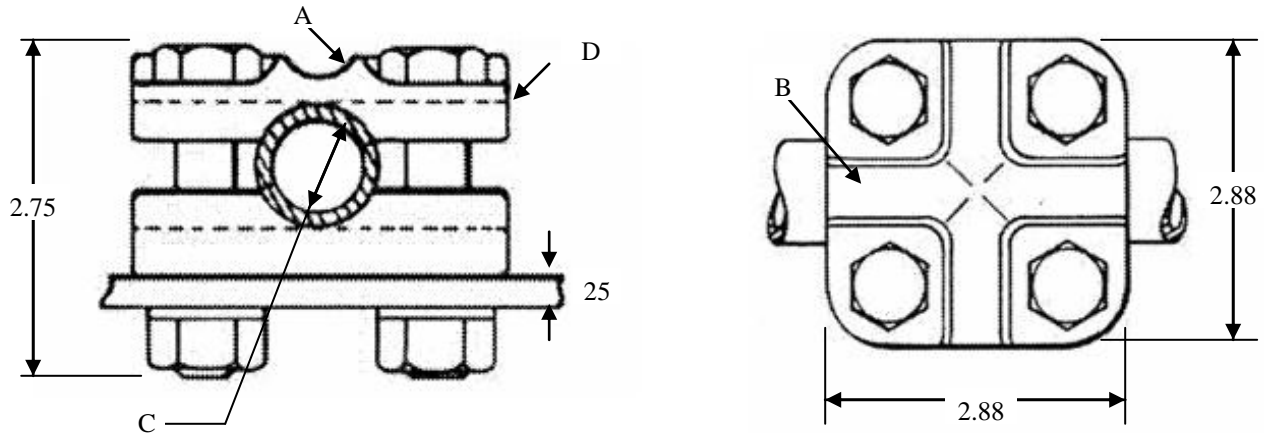

Connecteurs / Connectors

Numéro de catalogue. Catalog number.	Adaptation des Conducteurs Conductors Accommodated			
	Rainure A Groove A	Rainure B Groove B	Rainure C Groove C	Rainure D Groove D
<b>RPU132</b>	1/4" IPS 1/0-4/0 kcm	1/2" IPS 250-500 kcm	3/4" IPS 500-800 kcm	1" IPS 850-1250 kcm
<b>RPU132K</b> (ÉTAMÉ/ TINNED)	1/4" IPS 1/0-4/0 kcm	1/2" IPS 250-500 kcm	3/4" IPS 500-800 kcm	1" IPS 850-1250 kcm

**Matériel:** Cuivre ou Cuivre étamé  
**Material:** Copper or Tinned Copper

## CONNECTEUR UNIVERSEL / UNIVERSAL CONNECTOR

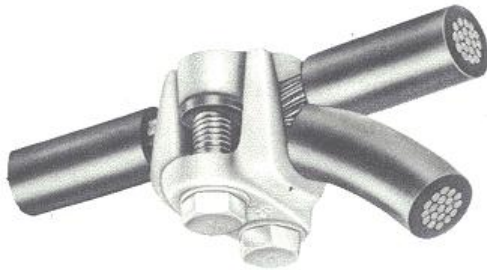

Type KVS

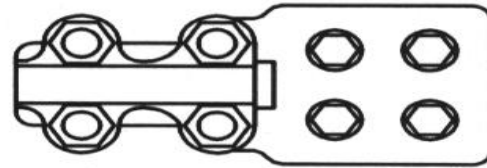

Tuyau ou cable a plage  
Tube or cable to flat

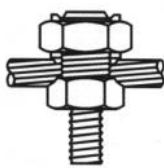
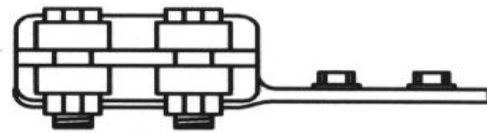

Type KC

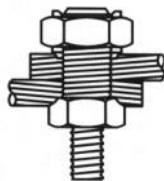

Type K2C

Boulon fendu  
Split bolt

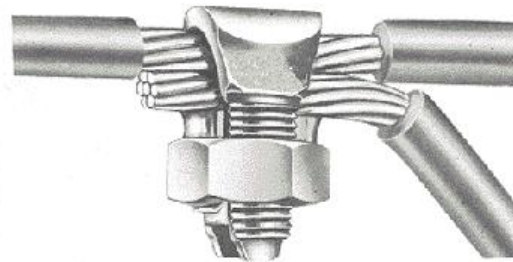

Boulon fendu Type KS  
Split bolt Type KS

Plusieurs dimensions et configurations disponibles.  
Contactez-nous  
Many sizes and configurations available.  
Contact-us

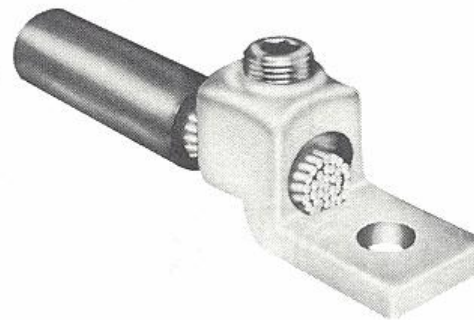

Cosse mécanique  
Mechanical lug

**Matériel:** Cuivre ou aluminium  
**Material:** Copper or aluminum

## CONNECTEURS / CONNECTORS

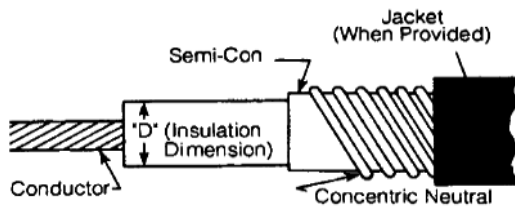

Connecteurs / Connectors

<b>25 KV 200 AMP LOADBREAK WITH TEST POINT</b>	
Numéro de Catalogue <u>CORP</u>	MIN-MAX Isolation (D) / Insulation (D)
Catalog Number <u>BODY</u>	po (mm) / in (mm)
<b>225LE40T</b>	0.80 - 1.14 (20.3–29.0)
<b>225LE50T</b>	0.92 – 1.31 (23.4–33.3)

Numéro de Catalogue <u>CONNECTEUR BIMÉTALIQUE</u>	Conducteurs	
	Conductors	
Catalog Number <u>CONNECTOR BIMETAL</u>	Stranded / Compressed	Solid / Compact
200LUGB1	6	4
200LUGB2	4	2
<b>200LUGB3</b>	2	1
<b>200LUGB4</b>	1	1/0
<b>200LUGB5</b>	1/0	2/0
<b>200LUGB6</b>	2/0	3/0
<b>200LUGB7</b>	3/0	4/0
<b>200LUGB8</b>	4/0	—

## Fiche Couder / Loadbreak Elbow



**INSULATING CAP 25KV**  
**CAT: 9U01BEW500**



**BUSHING INSERT 25KV**  
**CAT: 225BI**



**GROUNDING PARKING  
BUSHING 25KV**  
**CAT: 9U07BAF100**



**FEED-THRU 25KV**  
**CAT: 9U07BCF200 ,  
HORIZONTAL**



**INSULATED PARKING  
BUSHING 25KV**  
**CAT: 9U07BCF100**



**GROUNDING ELBOW**  
**25KV, MALT 1/0**  
**CAT: T6002131**

**TEST ROD**  
**CAT: 225STR**



**FEED-THRU INSERT 25KV**  
**CAT: 9U04BEB001**



Connecteurs / Connectors

## Fiche Couder / Loadbreak Elbow